



UL1077

UMBW

# Poles	Ampacity	Catalog Number			Max Voltage	List Price	Multiplier
		B CURVE	C CURVE	D CURVE			
1 POLE 	1	UMBW-1B1-1	UMBW-1C1-1	UMBW-1D1-1	277 VAC	\$25	Z12
	1.5	UMBW-1B1-1.5 ¹	UMBW-1C1-1.5 ¹	UMBW-1D1-1.5 ¹			
	2	UMBW-1B1-2	UMBW-1C1-2	UMBW-1D1-2			
	3	UMBW-1B1-3	UMBW-1C1-3	UMBW-1D1-3			
	4	UMBW-1B1-4	UMBW-1C1-4	UMBW-1D1-4			
	5	UMBW-1B1-5	UMBW-1C1-5	UMBW-1D1-5			
	6	UMBW-1B1-6	UMBW-1C1-6	UMBW-1D1-6			
	7	UMBW-1B1-7 ¹	UMBW-1C1-7 ¹	UMBW-1D1-7 ¹			
	8	UMBW-1B1-8 ¹	UMBW-1C1-8 ¹	UMBW-1D1-8 ¹			
	10	UMBW-1B1-10	UMBW-1C1-10	UMBW-1D1-10			
	12	UMBW-1B1-12	UMBW-1C1-12	UMBW-1D1-12			
	13	UMBW-1B1-13 ¹	UMBW-1C1-13 ¹	UMBW-1D1-13 ¹			
	15	UMBW-1B1-15	UMBW-1C1-15	UMBW-1D1-15			
	16	UMBW-1B1-16	UMBW-1C1-16	UMBW-1D1-16			
	20	UMBW-1B1-20	UMBW-1C1-20	UMBW-1D1-20			
	25	UMBW-1B1-25	UMBW-1C1-25	UMBW-1D1-25			
	30	UMBW-1B1-30 ¹	UMBW-1C1-30 ¹	UMBW-1D1-30 ¹			
	32	UMBW-1B1-32	UMBW-1C1-32	UMBW-1D1-32			
	35	UMBW-1B1-35 ¹	UMBW-1C1-35 ¹	UMBW-1D1-35 ¹			
	40	UMBW-1B1-40	UMBW-1C1-40	UMBW-1D1-40			
50	UMBW-1B1-50	UMBW-1C1-50	UMBW-1D1-50				
60	UMBW-1B1-60 ¹	UMBW-1C1-60 ¹	UMBW-1D1-60 ¹				
63	UMBW-1B1-63	UMBW-1C1-63	UMBW-1D1-63				
2 POLE 	1	UMBW-1B2-1	UMBW-1C2-1	UMBW-1D2-1	277/480 VAC	\$48	Z12
	1.5	UMBW-1B2-1.5 ¹	UMBW-1C2-1.5 ¹	UMBW-1D2-1.5 ¹			
	2	UMBW-1B2-2	UMBW-1C2-2	UMBW-1D2-2			
	3	UMBW-1B2-3	UMBW-1C2-3	UMBW-1D2-3			
	4	UMBW-1B2-4	UMBW-1C2-4	UMBW-1D2-4			
	5	UMBW-1B2-5	UMBW-1C2-5	UMBW-1D2-5			
	6	UMBW-1B2-6	UMBW-1C2-6	UMBW-1D2-6			
	7	UMBW-1B2-7 ¹	UMBW-1C2-7 ¹	UMBW-1D2-7 ¹			
	8	UMBW-1B2-8 ¹	UMBW-1C2-8 ¹	UMBW-1D2-8 ¹			
	10	UMBW-1B2-10	UMBW-1C2-10	UMBW-1D2-10			
	12	UMBW-1B2-12	UMBW-1C2-12	UMBW-1D2-12			
	13	UMBW-1B2-13 ¹	UMBW-1C2-13 ¹	UMBW-1D2-13 ¹			
	15	UMBW-1B2-15 ¹	UMBW-1C2-15 ¹	UMBW-1D2-15 ¹			
	16	UMBW-1B2-16	UMBW-1C2-16	UMBW-1D2-16			
	20	UMBW-1B2-20	UMBW-1C2-20	UMBW-1D2-20			
	25	UMBW-1B2-25	UMBW-1C2-25	UMBW-1D2-25			
	30	UMBW-1B2-30 ¹	UMBW-1C2-30 ¹	UMBW-1D2-30 ¹			
	32	UMBW-1B2-32	UMBW-1C2-32	UMBW-1D2-32			
	35	UMBW-1B2-35 ¹	UMBW-1C2-35 ¹	UMBW-1D2-35 ¹			
	40	UMBW-1B2-40	UMBW-1C2-40	UMBW-1D2-40			
50	UMBW-1B2-50	UMBW-1C2-50	UMBW-1D2-50				
60	UMBW-1B2-60 ¹	UMBW-1C2-60 ¹	UMBW-1D2-60 ¹				
63	UMBW-1B2-63	UMBW-1C2-63	UMBW-1D2-63				

1) Non-stocked. Contact WEG for availability.

UMBW

UL1077

# Poles	Ampacity	Catalog Number			Max Voltage	List Price	Multiplier
		B CURVE	C CURVE	D CURVE			
3 POLE	1	UMBW-1B3-1	UMBW-1C3-1	UMBW-1D3-1	277/480 VAC	\$65	Z12
	1.5	UMBW-1B3-1.5 ¹	UMBW-1C3-1.5 ¹	UMBW-1D3-1.5 ¹			
	2	UMBW-1B3-2	UMBW-1C3-2	UMBW-1D3-2			
	3	UMBW-1B3-3 ¹	UMBW-1C3-3 ¹	UMBW-1D3-3 ¹			
	4	UMBW-1B3-4	UMBW-1C3-4	UMBW-1D3-4			
	5	UMBW-1B3-5 ¹	UMBW-1C3-5 ¹	UMBW-1D3-5 ¹			
	6	UMBW-1B3-6	UMBW-1C3-6	UMBW-1D3-6			
	7	UMBW-1B3-7 ¹	UMBW-1C3-7 ¹	UMBW-1D3-7 ¹			
	8	UMBW-1B3-8 ¹	UMBW-1C3-8 ¹	UMBW-1D3-8 ¹			
	10	UMBW-1B3-10	UMBW-1C3-10	UMBW-1D3-10			
	12	UMBW-1B3-12 ¹	UMBW-1C3-12 ¹	UMBW-1D3-12 ¹			
	13	UMBW-1B3-13 ¹	UMBW-1C3-13 ¹	UMBW-1D3-13 ¹			
	15	UMBW-1B3-15 ¹	UMBW-1C3-15 ¹	UMBW-1D3-15 ¹			
	16	UMBW-1B3-16	UMBW-1C3-16	UMBW-1D3-16			
	20	UMBW-1B3-20	UMBW-1C3-20	UMBW-1D3-20			
	25	UMBW-1B3-25	UMBW-1C3-25	UMBW-1D3-25			
	30	UMBW-1B3-30 ¹	UMBW-1C3-30 ¹	UMBW-1D3-30 ¹			
	32	UMBW-1B3-32	UMBW-1C3-32	UMBW-1D3-32			
	35	UMBW-1B3-35 ¹	UMBW-1C3-35 ¹	UMBW-1D3-35 ¹			
	40	UMBW-1B3-40	UMBW-1C3-40	UMBW-1D3-40			
50	UMBW-1B3-50	UMBW-1C3-50	UMBW-1D3-50				
60	UMBW-1B3-60 ¹	UMBW-1C3-60 ¹	UMBW-1D3-60 ¹				
63	UMBW-1B3-63	UMBW-1C3-63	UMBW-1D3-63				

1) Non-stocked. Contact WEG for availability.



General Information

Circuit Protection

Disconnect Switches

Motor Protectors

Contactors

Overloads

Enclosed Starters

Relays

Pushbuttons and Pilot Lights



Terminal Blocks

Power Factor Correction

Appendix A

Appendix B

UL489

# Poles	Ampacity	Catalog Number			Max Voltage	List Price	Multiplier				
		B CURVE	C CURVE	D CURVE							
1 POLE 	1	UMBW-4B1-1	UMBW-4C1-1	UMBW-4D1-1	277 VAC /60 VDC	\$53	Z12				
	1.5	UMBW-4B1-1.5 ¹	UMBW-4C1-1.5 ¹	UMBW-4D1-1.5 ¹							
	2	UMBW-4B1-2	UMBW-4C1-2	UMBW-4D1-2							
	3	UMBW-4B1-3 ¹	UMBW-4C1-3 ¹	UMBW-4D1-3 ¹							
	4	UMBW-4B1-4	UMBW-4C1-4	UMBW-4D1-4							
	5	UMBW-4B1-5 ¹	UMBW-4C1-5 ¹	UMBW-4D1-5 ¹							
	6	UMBW-4B1-6	UMBW-4C1-6	UMBW-4D1-6							
	7	UMBW-4B1-7 ¹	UMBW-4C1-7 ¹	UMBW-4D1-7 ¹							
	8	UMBW-4B1-8 ¹	UMBW-4C1-8 ¹	UMBW-4D1-8 ¹							
	10	UMBW-4B1-10	UMBW-4C1-10	UMBW-4D1-10							
	12	UMBW-4B1-12 ¹	UMBW-4C1-12 ¹	UMBW-4D1-12 ¹							
	13	UMBW-4B1-13 ¹	UMBW-4C1-13 ¹	UMBW-4D1-13 ¹							
	15	UMBW-4B1-15	UMBW-4C1-15	UMBW-4D1-15							
	16	UMBW-4B1-16	UMBW-4C1-16	UMBW-4D1-16							
	20	UMBW-4B1-20	UMBW-4C1-20	UMBW-4D1-20							
	25	UMBW-4B1-25	UMBW-4C1-25	UMBW-4D1-25							
	2 POLE 	1	UMBW-4B2-1	UMBW-4C2-1				UMBW-4D2-1	277/480 VAC 125 VDC	\$107	Z12
		1.5	UMBW-4B2-1.5 ¹	UMBW-4C2-1.5 ¹				UMBW-4D2-1.5 ¹			
2		UMBW-4B2-2	UMBW-4C2-2	UMBW-4D2-2							
3		UMBW-4B2-3 ¹	UMBW-4C2-3 ¹	UMBW-4D2-3 ¹							
4		UMBW-4B2-4	UMBW-4C2-4	UMBW-4D2-4							
5		UMBW-4B2-5	UMBW-4C2-5	UMBW-4D2-5							
6		UMBW-4B2-6	UMBW-4C2-6	UMBW-4D2-6							
7		UMBW-4B2-7 ¹	UMBW-4C2-7 ¹	UMBW-4D2-7 ¹							
8		UMBW-4B2-8 ¹	UMBW-4C2-8 ¹	UMBW-4D2-8 ¹							
10		UMBW-4B2-10	UMBW-4C2-10	UMBW-4D2-10							
12		UMBW-4B2-12	UMBW-4C2-12	UMBW-4D2-12							
13		UMBW-4B2-13 ¹	UMBW-4C2-13 ¹	UMBW-4D2-13 ¹							
15		UMBW-4B2-15 ¹	UMBW-4C2-15 ¹	UMBW-4D2-15 ¹							
16		UMBW-4B2-16	UMBW-4C2-16	UMBW-4D2-16							
20		UMBW-4B2-20	UMBW-4C2-20	UMBW-4D2-20							
25		UMBW-4B2-25	UMBW-4C2-25	UMBW-4D2-25							
30		UMBW-4B2-30 ¹	UMBW-4C2-30 ¹	UMBW-4D2-30 ¹							
32		UMBW-4B2-32	UMBW-4C2-32	UMBW-4D2-32							
35	UMBW-4B2-35 ¹	UMBW-4C2-35 ¹	UMBW-4D2-35 ¹								
40	UMBW-4B2-40 ¹	UMBW-4C2-40 ¹	UMBW-4D2-40 ¹								
50	UMBW-4B2-50 ¹	UMBW-4C2-50 ¹	UMBW-4D2-50 ¹								
60	UMBW-4B2-60 ¹	UMBW-4C2-60 ¹	UMBW-4D2-60 ¹								
63	UMBW-4B2-63 ¹	UMBW-4C2-63 ¹	UMBW-4D2-63 ¹								

1) Non-stocked. Contact WEG for availability.

- General Information
- Circuit Protection
- Disconnect Switches
- Motor Protectors
- Contactors
- Overloads
- Enclosed Starters
- Relays
- Pushbuttons and Pilot Lights
- Terminal Blocks
- Power Factor Correction
- Appendix A
- Appendix B

UMBW

UL489

# Poles	Ampacity	Catalog Number			Max Voltage	List Price	Multiplier
		B CURVE	C CURVE	D CURVE			
3 POLE 	1	UMBW-4B3-1	UMBW-4C3-1	UMBW-4D3-1	277/480 VAC 125 VDC	\$158	Z12
	1.5	UMBW-4B3-1.5 ¹	UMBW-4C3-1.5 ¹	UMBW-4D3-1.5 ¹			
	2	UMBW-4B3-2	UMBW-4C3-2	UMBW-4D3-2			
	3	UMBW-4B3-3 ¹	UMBW-4C3-3 ¹	UMBW-4D3-3 ¹			
	4	UMBW-4B3-4	UMBW-4C3-4	UMBW-4D3-4			
	5	UMBW-4B3-5	UMBW-4C3-5	UMBW-4D3-5			
	6	UMBW-4B3-6	UMBW-4C3-6	UMBW-4D3-6			
	7	UMBW-4B3-7 ¹	UMBW-4C3-7 ¹	UMBW-4D3-7 ¹			
	8	UMBW-4B3-8 ¹	UMBW-4C3-8	UMBW-4D3-8			
	10	UMBW-4B3-10	UMBW-4C3-10	UMBW-4D3-10			
	12	UMBW-4B3-12 ¹	UMBW-4C3-12 ¹	UMBW-4D3-12 ¹			
	13	UMBW-4B3-13 ¹	UMBW-4C3-13 ¹	UMBW-4D3-13 ¹			
	15	UMBW-4B3-15	UMBW-4C3-15	UMBW-4D3-15			
	16	UMBW-4B3-16	UMBW-4C3-16	UMBW-4D3-16			
	20	UMBW-4B3-20	UMBW-4C3-20	UMBW-4D3-20			
	25	UMBW-4B3-25	UMBW-4C3-25	UMBW-4D3-25			
	30	UMBW-4B3-30 ¹	UMBW-4C3-30 ¹	UMBW-4D3-30 ¹			
	32	UMBW-4B3-32	UMBW-4C3-32	UMBW-4D3-32			
	35	UMBW-4B3-35 ¹	UMBW-4C3-35 ¹	UMBW-4D3-35 ¹			
40	UMBW-4B3-40 ¹	UMBW-4C3-40 ¹	UMBW-4D3-40 ¹				
50	UMBW-4B3-50 ¹	UMBW-4C3-50 ¹	UMBW-4D3-50 ¹				
60	UMBW-4B3-60 ¹	UMBW-4C3-60 ¹	UMBW-4D3-60 ¹				
63	UMBW-4B3-63 ¹	UMBW-4C3-63 ¹	UMBW-4D3-63 ¹	240 VAC / 125 VDC	\$158	Z12	

1) Non-stocked. Contact WEG for availability.

- General Information
- Circuit Protection
- Disconnect Switches
- Motor Protectors
- Contactors
- Overloads
- Enclosed Starters
- Relays
- Pushbuttons and Pilot Lights
- Terminal Blocks
- Power Factor Correction
- Appendix A
- Appendix B

Miniature Circuit Breakers

Accessories

Auxiliary Contact	1NO/1NC
Shunt Trip	120,240,277AC...12,24,48,125DC
Bell Alarm	1NO/1NC
Bus Bar	1,2,3 Phase...1,2,3 Phase with Auxiliary

Auxiliary Contacts

Signaling contacts that open and close with the breaker. Provide remote status indicating ON and OFF only.

For Use With	Catalog Number	Operating Voltage	Operating Amperage	Contacts	Mounting/Dims (mm)	Mechanical Operations	Torque	Mass	QTY	List Price	Multiplier
UMBW-1 UMBW-4	UMBW-AUX	12-240VAC	6A	1NO/1NC	Field Mountable..Left Side/ 9mm	20,000	1 Nm .74 Ft. lbs.	29g	1	\$55	Z12
		277VAC	3A								
		12-24VDC	6A								
		48VDC	3A								
		110-220VDC	1.5A								

Bell Alarm

Provides provisions for visual and alarm indication when the breaker in the Tripped status, due to Short Circuit, Overload or Undervoltage. Breaker must be re-set to open contacts.

For Use With	Catalog Number	Operating Voltage	Operating Amperage	Contacts	Mounting/Dims (mm)	Mechanical Operations	Torque	Mass	QTY	List Price	Multiplier
UMBW-1 UMBW-4	UMBW-BAC	12-240VAC	6A	1NO/1NC	Field Mountable..Left Side/ 9mm	10,000	1 Nm .74 Ft. lbs.	29g	1	\$68	Z12
		277VAC	3A								
		12-24VDC	6A								
		48VDC	3A								
		110-220VDC	1.5A								

Shunt Trip

Provides ability to trip breaker from remote location when power is applied.

For Use With	Catalog Number	Voltage/Min Trip Voltage	Amperage/Power Consumption	Contacts	Mounting/Dims (mm)	Mechanical Operations	Torque	Mass	QTY	List Price	Multiplier
UMBW-1 UMBW-4	UMBW-ST12DC	12 VDC/ 8VDC	6A/ 200W	1NO/1NC	Field Mountable..Left Side/18mm	20,000	1Nm, .74ft lbs	60g	1	\$95	Z12
	UMBW-ST24DC	24 VDC/ 16VDC	6A/ 200W							\$95	
	UMBW-ST48DC	48 VDC/ 24VDC	2A/ 200W							\$95	
	UMBW-ST125DC	125 VDC/ 80VDC	1.5A/ 200W							\$95	
	UMBW-ST120AC	120 VAC/ 80VAC	6A/ 200W							\$95	
	UMBW-ST240AC	240 VAC/ 160VAC	6A/ 200W							\$95	
	UMBW-ST277AC	277 VAC/ 160VAC	3A/ 200W							\$95	

- General Information
- Circuit Protection
- Disconnect Switches
- Motor Protectors
- Contactor
- Overloads
- Enclosed Starters
- Relays
- Pushbuttons and Pilot Lights
- Terminal Blocks
- Power Factor Correction
- Appendix A
- Appendix B

UMBW

Minature Circuit Breakers

Bus Bar Accessories

For Use With	Catalog Number	AMP Rating End/Center	Number of Poles	Max Voltage	Length (mm)	QTY	List Price	End Cap Catalog Number (Sold as Seprate Item)	QTY	List Price	Multiplier
1 Pole											
UMBW-1	UMBW-BB-1-1 	80A/160A	57	600 AC /1000 DC	1009	1	\$125	UMBW-BB-1-1P-END CAP	10 (Sets of 2pcs)	\$30	Z12
UMBW-4	UMBW-BB-4-1	80A/160A	57	1000 AC/DC	1031	1	\$500	UMBW-BB-4-END CAP	10	\$35	
1 Pole with Auxiliary											
UMBW-1	UMBW-BB-1-1A 	80A/160A	37	600 AC /1000 DC	985	1	\$135	UMBW-BB-1-1P-END CAP	10 (Sets of 2pcs)	\$30	Z12
UMBW-4	UMBW-BB-4-1A	80A/160A	37	1000 AC/DC	972	1	\$570	UMBW-BB-4-END CAP	10	\$35	
2 POLE											
UMBW-1	UMBW-BB-1-2 	80A/160A	56	600 AC/DC	991	1	\$285	UMBW-BB-1-2/3P-E CAP	10 (Sets of 2pcs)	\$30	Z12
UMBW-4	UMBW-BB-4-2	80A/160A	56	600 AC/DC	979	1	\$575	UMBW-BB-4-END CAP	10	\$35	
2 Pole with Auxiliary											
UMBW-1	UMBW-BB-1-2A 	80A/160A	46	600 AC/DC	1009	1	\$295	UMBW-BB-1-2/3P-E CAP	10 (Sets of 2pcs)	\$30	Z12
UMBW-4	UMBW-BB-4-2A	80A/160A	46	600 AC/DC	981	1	\$645	UMBW-BB-4-END CAP	10	\$35	
3 Pole											
UMBW-1	UMBW-BB-1-3 	80A/160A	57	600 AC/DC	1009	1	\$340	UMBW-BB-1-2/3P-E CAP	10 (Sets of 2pcs)	\$30	Z12
UMBW-4	UMBW-BB-4-3	80A/160A	57	600 AC/DC	997	1	\$650	UMBW-BB-4-END CAP	10	\$35	
3 Pole with Auxiliary											
UMBW-1	UMBW-BB-1-3A 	80A/160A	48	600 AC/DC	982	1	\$345	UMBW-BB-1-2/3P-E CAP	10 (Sets of 2pcs)	\$30	Z12
UMBW-4	UMBW-BB-4-3A	80A/160A		600 AC/DC	936	1	\$720	UMBW-BB-4-END CAP	10	\$35	

Note: Bus Bars May Be Center Fed to Increase Ampacity to Double Rated Value

General Information

Circuit Protection

Disconnect Switches

Motor Protectors

Contactors

Overloads

Enclosed Starters

Relays

Pushbuttons and Pilot Lights

Terminal Blocks

Power Factor Correction

Appendix A

Appendix B

Miniature Circuit Breakers

Bus Bar Accessories

For Use With	Catalog Number	AMP Rating	Number of Poles	Max Voltage	Conductor Range Min/Max	Tightening Torque	QTY	List Price	Multiplier
UMBW-1	UMBW-BB-1-1P-END CAP	N/A	1	N/A	N/A	N/A	10	\$30	Z12
UMBW-1	UMBW-BB-1-2/3-E-CAP	N/A	2 or 3	N/A	N/A	N/A	10 (Sets of 2pcs)	\$35	Z12
UMBW-1	UMBW-BB-1-1P-TERM	115A	1	1000 AC/DC	10AWG/1AWG	50 lb.in	10	\$320	Z12
UMBW-1	UMBW-BB-1-2/3P-TERM	115A	2 or 3	1000 AC/DC	10AWG/1AWG	50 lb.in	10	\$330	Z12
UMBW-1	UMBW-BB-1-BUS CAP-Y	N/A	5	N/A	N/A	N/A	10 (Sets of 5pcs)	\$115	Z12

For Use With	Catalog Number	AMP Rating	Number of Poles	Max Voltage	Conductor Range Min/Max	Tightening Torque	QTY	List Price	Multiplier
UMBW-4	UMBW-BB-4-END CAP	N/A		N/A	N/A	N/A	10	\$40	Z12
UMBW-4	UMBW-BB-4-1P-TERM	115A	1	1000 AC/DC	14AWG/2AWG	50 lb.in	10	\$350	Z12
UMBW-4	UMBW-BB-4-BUS CAP-Y	N/A	3	N/A	N/A	N/A	10 (Sets of 3pcs)	\$45	Z12

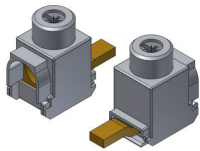

UMBW-BB-1-1-TERM

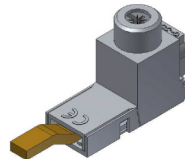

UMBW-BB-1-2/3P-TERM



UMBW-BB-1-BUS CAP-Y

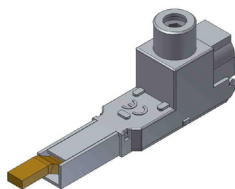

UMBW-BB-4-1P-TERM



UMBW-BB-4-BUS CAP-Y

General Information

Circuit Protection

Disconnect Switches

Motor Protectors

Contactors

Overloads

Enclosed Starters

Relays

Pushbuttons and Pilot Lights

Terminal Blocks

Power Factor Correction

Appendix A

Appendix B

UMBW

Breaker Technical Data

Electrical Ratings

Approval	Poles	Voltage	Ampacity	Interrupting
UL1077 E468808	1 Pole	240VAC	1A - 63A	7.5kA
	1 Pole	277VAC	1A - 63A	5kA
	2,3 Pole	240VAC	1A - 63A	5kA
	2, 3 Pole	277/480Y VAC	1A - 63A	5kA
	1 Pole	60VDC - pending	1A - 63A	7.5kA
	2 Pole	125VDC - pending	1A - 63A	7.5kA
UL489 E468810	1 Pole	120VAC	1A - 63A	10kA
	2, 3 Pole	240VAC	1A - 63A	10kA
	1 Pole	277VAC	1A - 20A	10kA
	2, 3 Pole	277/480Y VAC	1A - 20A	10kA
	1 Pole	60VDC	1A - 63A	10kA
	2 Pole	125VDC	1A - 63A	10kA
IEC 60947-2	1 Pole	230VAC	1A - 63A	10kA
	2, 3 Pole	400VAC	1A - 63A	10kA

Mechanical Ratings

Tripping Curves	B,C,D
Number of Poles	1,2,3
Mounting Position	Vertical, Horizontal
Torque	2 Nm, 1.48 ft lbs Maximum
Cable Cross Section	35mm sq, 2 Awg Maximum
Ambient Temperature	-35 deg C to +70 deg C
Mass	UL1077 - 116 grams per pole
	UL489 - 131 grams per pole
Protection Class	IP20
Mechanical Operations	10,000
Vibration (sinusoidal)	+/- .38mm (10-57HZ), 5g
Test to IEC 60060-2-6	(57-500HZ)
Test to Fc	10 frequency cycles per axis
Shock Test to IEC60068-2-27, Test Ea	30g (11ms)
Corrosion Test to IEC60068-2-11 Test Ka	96hrs in 5% salt mist
Humidity Test to IEC60068-2-78 Test Cab	48hrs at 95% RH, Temp +40 deg C
Terminals	Screw with Bus Bar Connections

Operating Ampacity Based on Ambient Temperature (Degree C)

Amps	-35	-30	-25	-20	-15	-10	-5	0	+5	+10	+15	+20	+25	+30	+35	+40	+45	+50	+55	+60	+65	+70
1	1.3	1.3	1.2	1.2	1.2	1.2	1.2	1.1	1.1	1.1	1.1	1.1	1.0	1.0	1.0	0.9	0.9	0.9	0.9	0.8	0.8	0.8
2	2.5	2.5	2.5	2.4	2.4	2.3	2.3	2.3	2.2	2.2	2.1	2.1	2.0	2.0	1.9	1.9	1.8	1.8	1.7	1.7	1.6	1.5
4	5.1	5.0	4.9	4.8	4.8	4.7	4.6	4.5	4.4	4.3	4.2	4.2	4.1	4.0	3.9	3.8	3.6	3.6	3.4	3.3	3.2	3.1
6	7.7	7.6	7.5	7.3	7.2	7.1	7.0	6.8	6.7	6.6	6.4	6.3	6.1	6.0	5.8	5.7	5.5	5.4	5.2	5.0	4.8	4.6
10	13.9	13.6	13.4	13.1	12.8	12.5	12.2	11.9	11.6	11.3	11.0	10.7	10.3	10.0	9.6	9.2	8.9	8.5	8.0	7.6	7.1	6.6
16	20.8	20.4	20.1	19.8	19.4	19.1	18.7	18.3	18.0	17.6	17.2	16.8	16.4	16.0	15.6	15.1	14.7	14.2	13.7	13.2	12.7	12.8
20	25.7	25.3	24.9	24.5	24.1	23.6	23.2	22.8	22.3	21.9	21.4	21.0	20.5	20.0	19.5	19.0	18.4	17.9	17.3	16.7	16.1	15.5
25	32.2	31.7	31.2	30.7	30.2	29.7	29.1	28.6	28.0	27.4	26.8	26.2	25.6	25.0	24.3	23.7	23.0	22.3	21.6	20.8	20.0	19.2
32	41.0	40.5	39.8	39.2	38.5	37.8	37.2	36.5	35.8	35.0	34.3	33.5	32.8	32.0	31.2	30.3	29.5	28.7	27.7	26.8	25.8	24.8
40	51.6	50.9	50.0	49.2	48.4	47.5	46.6	45.7	44.8	43.9	43.0	42.0	41.0	40.0	38.9	37.9	36.8	35.6	34.4	33.2	32.0	30.6
50	64.9	64.0	62.9	61.9	60.8	59.7	58.5	57.4	56.2	55.1	53.8	52.6	51.3	50.0	47.8	46.2	44.8	43.3	41.8	40.2	38.6	35.8
63	83.5	82.1	80.6	79.2	77.7	76.2	74.7	73.1	71.5	69.9	68.2	66.5	64.8	63.0	60.1	58.2	56.2	54.2	52.0	49.8	47.5	43.1

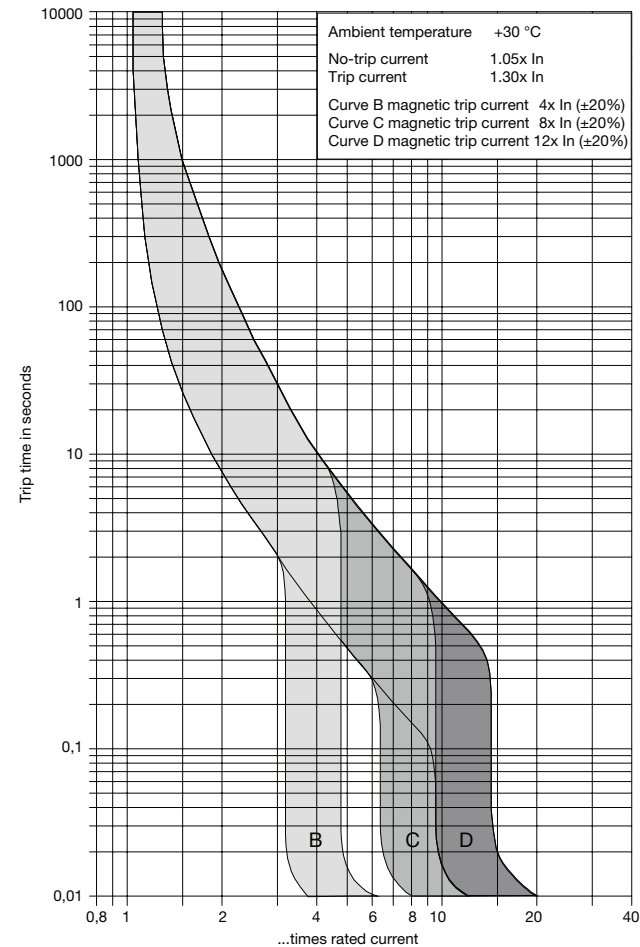

Magnetic tripping currents are increased by 30 % on DC supplies.

B CURVE- Tripping Characteristics:
 Calibrated for resistive or non/low inductive loads.
 Applications: Lighting, Control Circuits

C CURVE- Tripping Characteristics:
 Calibrated for general purpose inductive loads.
 Applications: Fluorecent lighting, midrange inductive motors

D CURVE- Tripping Characteristics:
 Calibrated for inductive loads with high inrush currents
 Applications: Motors, Transformers

General Information

Circuit Protection

Disconnect Switches

Motor Protectors

Contactors

Overloads

Enclosed Starters

Relays

Pushbuttons and Pilot Lights

Terminal Blocks

Power Factor Correction

Appendix A

Appendix B

UMBW

Dimensions (mm)

U **UMBW - 4 (UL489)**

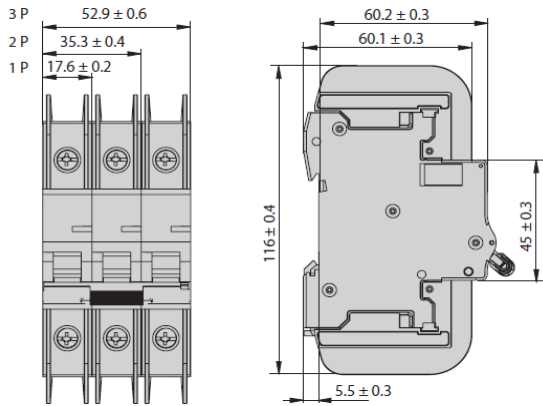

UMBW - 1 (UL1077)

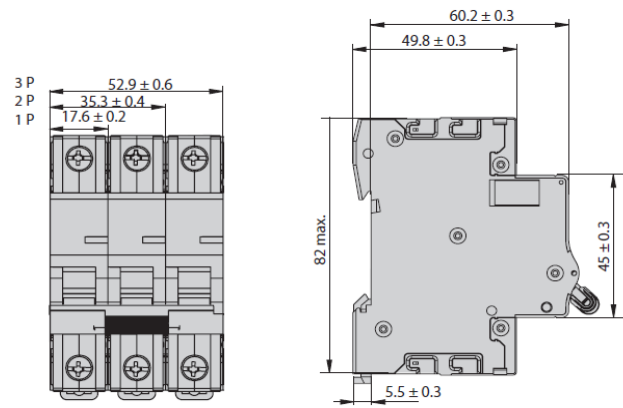

UMBW - AUX

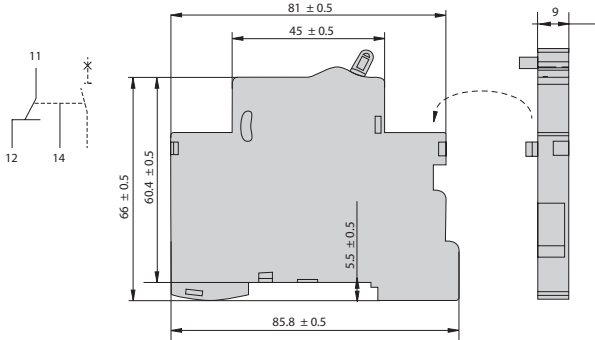

UMBW - BAC

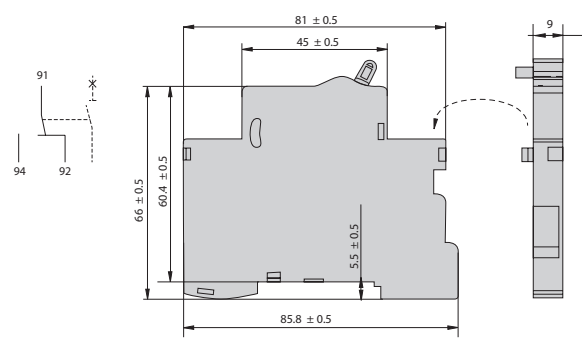

UMBW - AUX

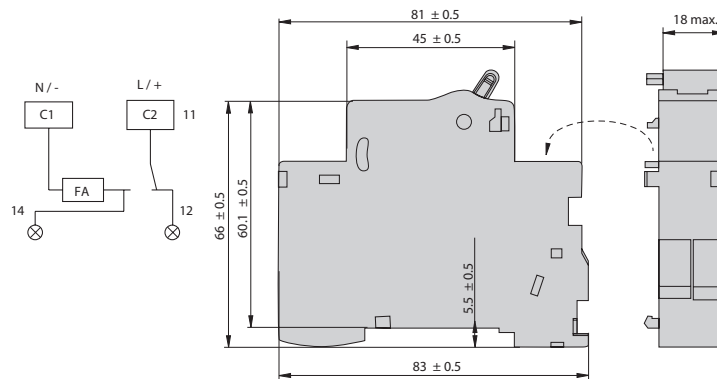

General Information

Circuit Protection

Disconnect Switches

Motor Protectors

Contactors

Overloads

Enclosed Starters

Relays

Pushbuttons and Pilot Lights

Terminal Blocks

Power Factor Correction

Appendix A

Appendix B

Circuit Protection

UMBW

General Information

Circuit Protection

Disconnect Switches

Motor Protectors

Contactors

Overloads

Enclosed Starters

Relays

Pushbuttons and Pilot Lights

Terminal Blocks

Power Factor Correction

Appendix A

Appendix B

UMBW-BB-1-3

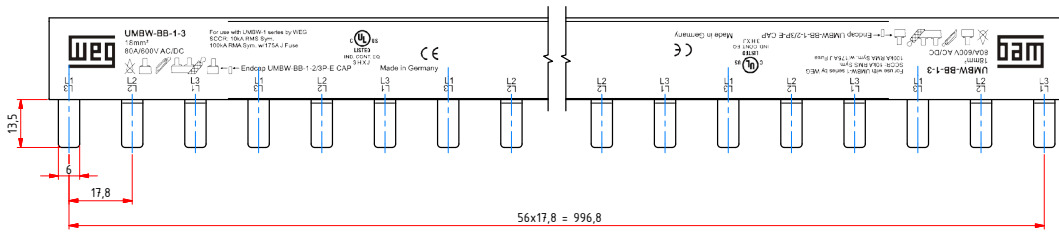

UMBW-BB-1-3A

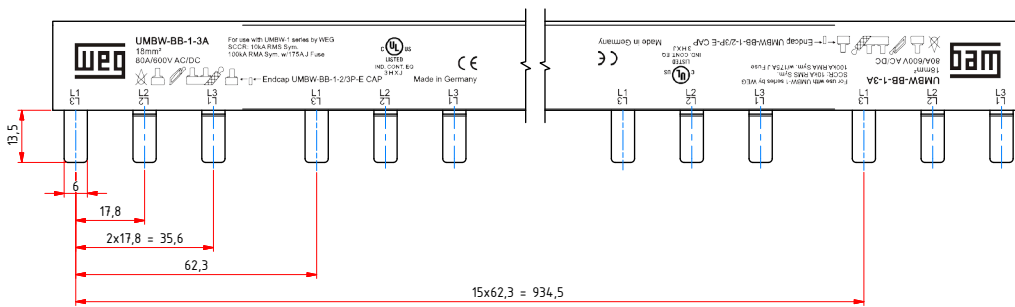
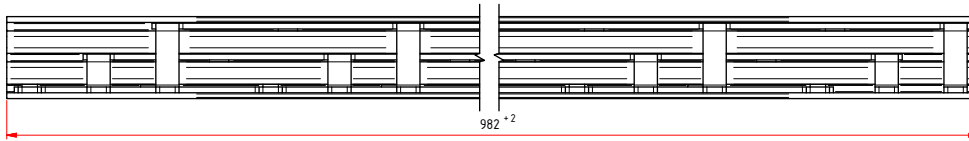

UMBW-BB-1-1P-TERM

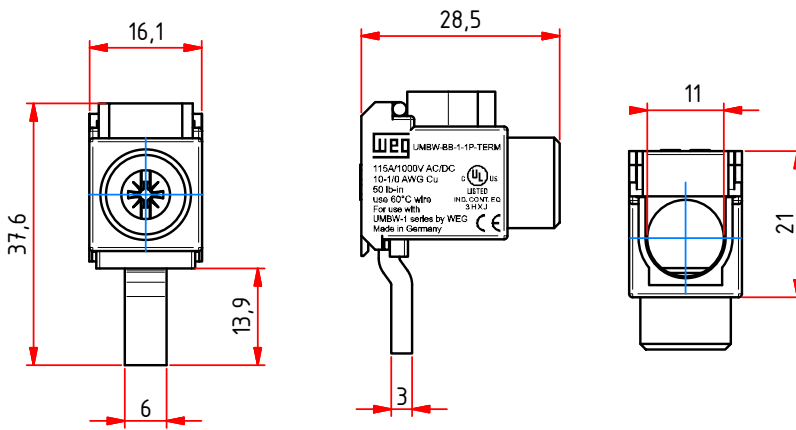

UMBW-BB-1-2/3P-TERM

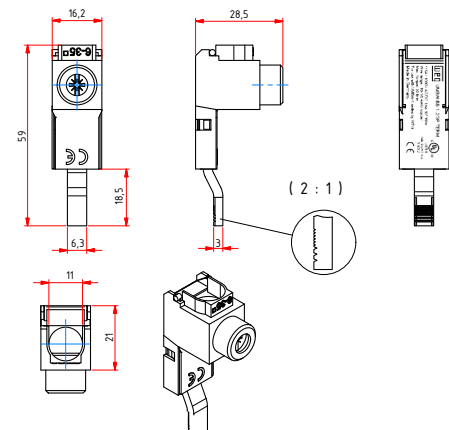

UMBW-BB-4-1

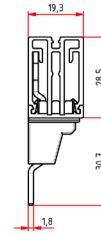
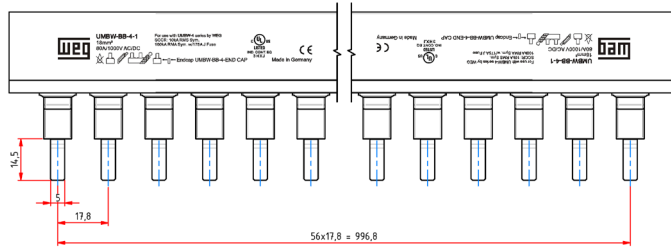
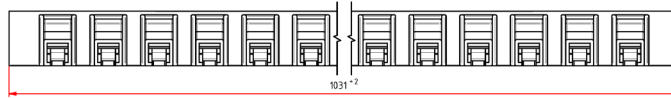

UMBW-BB-4-1A

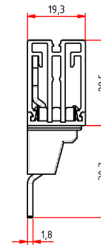
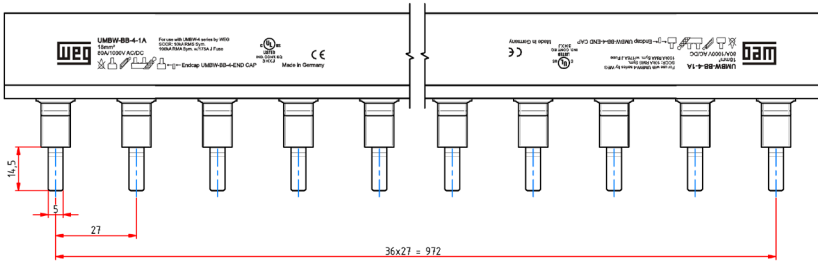
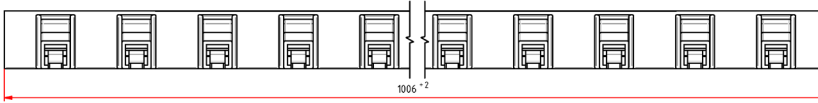

UMBW-BB-4-2

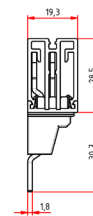
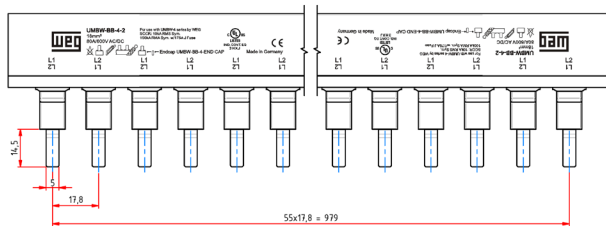
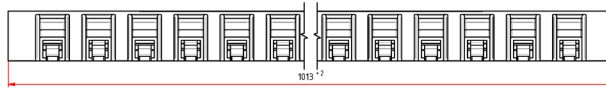

UMBW-BB-4-2A

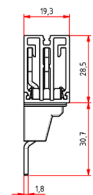
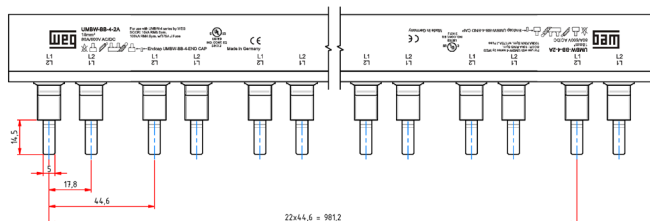
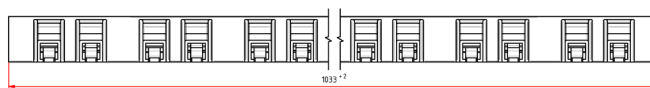

General Information

Circuit Protection

Disconnect Switches

Motor Protectors

Contactors

Overloads

Enclosed Starters

Relays

Pushbuttons and Pilot Lights

Terminal Blocks

Power Factor Correction

Appendix A

Appendix B

General Information

Circuit Protection

Disconnect Switches

Motor Protectors

Contactors

Overloads

Enclosed Starters

Relays

Pushbuttons and Pilot Lights

Terminal Blocks

Power Factor Correction

Appendix A

Appendix B

UMBW

UMBW-BB-4-3

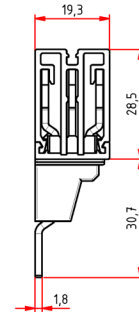
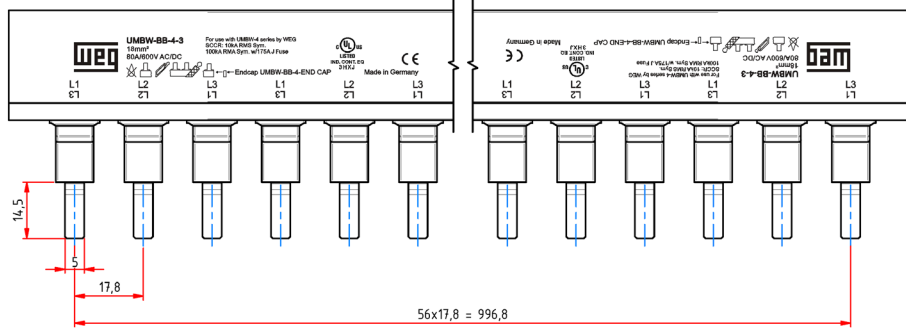
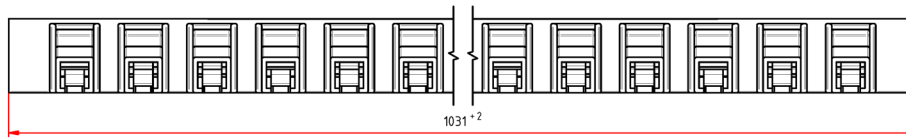

UMBW-BB-4-3A

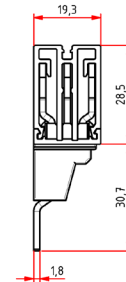
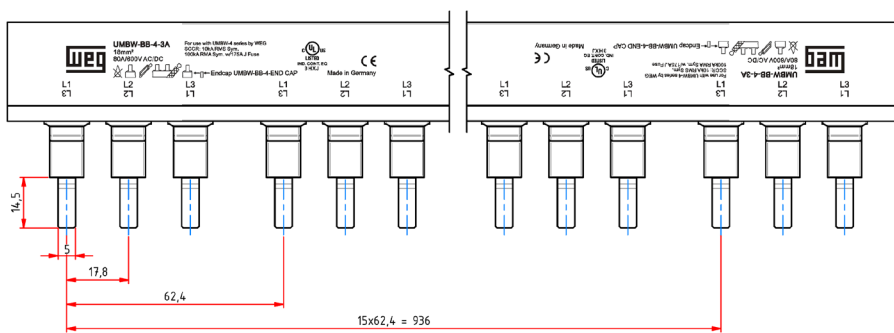
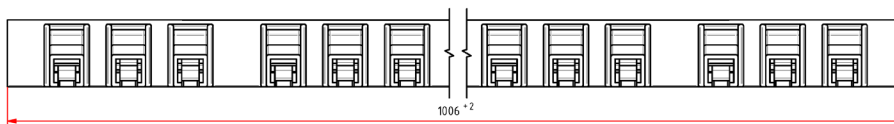

UMBW-BB-4-1P-TERM

